

TDS
Technical Data Sheet

Release Date
2023



The MS series consists of single-sided or double-sided cabinets with a rational, minimalist design. Their clean lines and practicality make them suitable companions for all of UniFor's products.

The single-sided version features two overlapping sliding doors and a lock with removable core located on the front side of the top. The double-sided version has one sliding door per side. They slide from right to left, overlapping with the back of the adjacent compartment. In this case, each of the two compartments has its own lock with removable core, positioned on each side of the top.

Both versions, in melamine laminate, steel, or wood, are available in various sizes and heights and include a central reinforcement panel. The sliding doors are finished to match the structure of the cabinets, while the rails are in aluminium with a nylon profile.

The cabinets are completed with shelving that can be installed at various heights, a drawer, and file holder frames. The series also includes a printer station configuration, as well as a recycling station configuration complete with recycling bins.

The modularity of the MS system makes it easy to transform the cabinets into structural support components that can be combined with other elements from the various UniFor furnishing series.

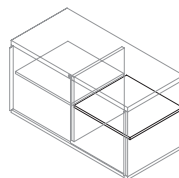
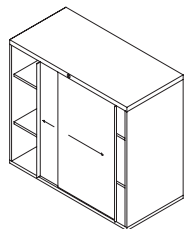
**SINGLE-SIDED SLIDING DOORS
CABINETS**
**Single-sided MS cabinets
length 100 cm**

Shelves not included

 100×48×H53 cm
 U MS 100 53 M ..

 100×48×H66 cm
 U MS 100 66 M ..

 100×48×H91 cm
 U MS 100 91 M ..

 100×48×H110 cm
 U MS 100 110 M ..

 100×48×H128 cm
 U MS 100 128 M ..

**Shelf for cabinet
length 100 cm**

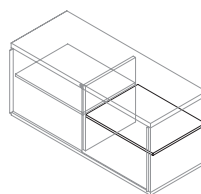
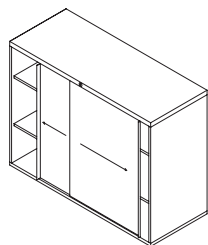
 50×43×H2,2 cm
 U MS RI 50 48 M ..

**Single-sided MS cabinets
length 120 cm**

Shelves not included

 120×48×H53 cm
 U MS 120 53 M ..

 120×48×H66 cm
 U MS 120 66 M ..

 120×48×H91 cm
 U MS 120 91 M ..

 120×48×H110 cm
 U MS 120 110 M ..

 120×48×H128 cm
 U MS 120 128 M ..

**Shelf for cabinet
length 120 cm**

 60×43×H2,2 cm
 U MS RI 60 48 M ..

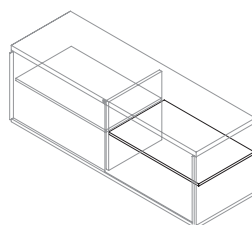
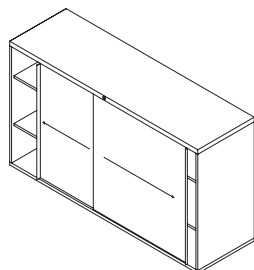
**SINGLE-SIDED SLIDING DOORS
CABINETS**
**Single-sided MS cabinets
length 160 cm**

Shelves not included

 160×48×H53 cm
 U MS 160 53 M ..

 160×48×H66 cm
 U MS 160 66 M ..

 160×48×H91 cm
 U MS 160 91 M ..

 160×48×H110 cm
 U MS 160 110 M ..

 160×48×H128 cm
 U MS 160 128 M ..

**Shelf for cabinet
length 160 cm**

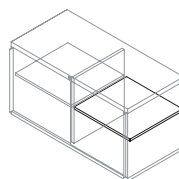
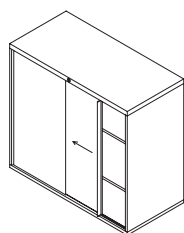
 80×43×H2,2 cm
 U MS RI 80 48 M ..

**DOUBLE-SIDED SLIDING DOORS
CABINETS**
**Double-sided MS cabinet
length 100 cm**

Shelves not included)

 100×48×H53 cm
 U MS 100 53 B ..

 100×48×H66 cm
 U MS 100 66 B ..

 100×48×H91 cm
 U MS 100 91 B ..

 100×48×H110 cm
 U MS 100 110 B ..

 100×48×H128 cm
 U MS 100 128 B ..

**Shelf for cabinet
length 100 cm**

 50×42×H2,2 cm
 U MS RI 50 48 B ..

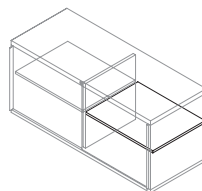
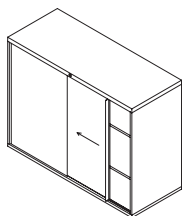
**DOUBLE-SIDED SLIDING DOORS
CABINETS**
**Double-sided MS cabinet
length 120 cm**

(Shelves not included)

 120×48×H53 cm
 U MS 120 53 B ..

 120×48×H66 cm
 U MS 120 66 B ..

 120×48×H91 cm
 U MS 120 91 B ..

 120×48×H110 cm
 U MS 120 110 B ..

 120×48×H128 cm
 U MS 120 128 B ..

**Shelf for cabinet
length 120 cm**

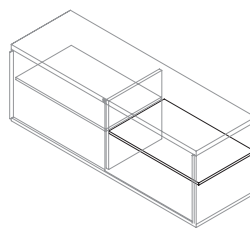
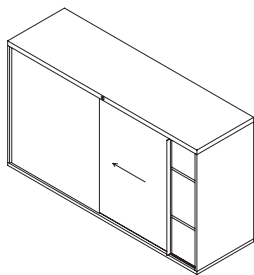
 60×42×H2,2 cm
 U MS RI 60 48 B ..

**Double-sided MS cabinet
length 160 cm**

(Shelves not included)

 160×48×H53 cm
 U MS 160 53 B ..

 160×48×H66 cm
 U MS 160 66 B ..

 160×48×H91 cm
 U MS 160 91 B ..

 160×48×H110 cm
 U MS 160 110 B ..

 160×48×H128 cm
 U MS 160 128 B ..

**Shelf for cabinet
length 160 cm**

 60×42×H2,2 cm
 U MS RI 80 48 B ..

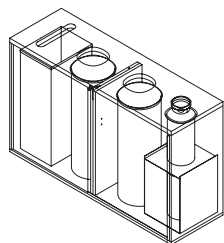
**Recycling unit**

It includes 1 paper bin,
1 non-recyclable waste,
2 liquid waste
and 1 plastic bin

160x48xH91,1 cm
U MS 160 91 RU ..

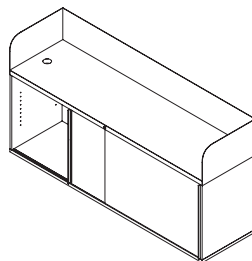
**Print unit**

160x48xH91,1 cm
U MS 160 91 PU ..

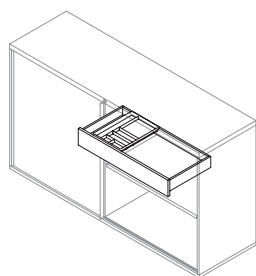
**Extractable internal drawer**

For cabinet length 100 cm
50x45xH24 cm
U MS CA 50 48 ..

For cabinet length 120 cm
60x45xH24 cm
U MS CA 60 48 ..

For cabinet length 160 cm
80x45xH24 cm
U MS CA 80 48 ..

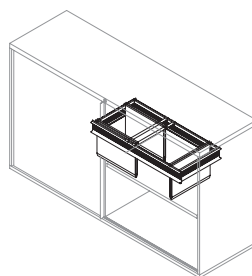
**Extractable filing frame**

For cabinet length 100 cm
50x45xH16 cm
U MS TL 50 48 ..

For cabinet length 120 cm
60x45xH16 cm
U MS TL 60 48 ..

For cabinet length 160 cm
80x45xH16 cm
U MS TL 80 48 ..

ACCESSORIES

STRUCTURE AND SLIDING DOORS FINISHES

Melamine/Epoxy powder coating



4S/C7
Structure:
White melamine
Doors:
Calce White painting



PN/VP
Structure:
Platinum Grey melamine
Doors:
Platinum Grey painting

Epoxy powder coating



C7/C7
Structure and doors:
Calce White painting



VP/VP
Structure and doors:
Platinum Grey painting

Standard natural veneer
(certified genuine wood
from Europe-Canada-USA)



AS/AS
Structure and doors:
Sycamore



RV/RV
Structure and doors:
Natural Oak

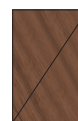

NK/NK
Structure and doors:
Canaletto Walnut
straight-grained

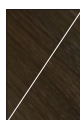

5R/5R
Structure and doors:
Thermo-treated Oak

SHELVES AND FRONT PULL-OUT INTERNAL DRAWER FINISHES

Melamine



4S
White melamine



PN
Platinum Grey melamine

Epoxy powder coating



VP
Platinum Grey painting



C7
Calce White painting

Standard natural veneer
(certified genuine wood
from Europe-Canada-USA)



AS
Sycamore



RV
Natural Oak

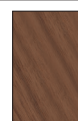

NK
Canaletto Walnut
straight-grained



5R
Thermo-treated Oak

The prices of the cabinets are not inclusive of filing shelves

Number of recommended shelves per cabinet

H53 cm	2 shelves
H66 cm	2 shelves
H91 cm	4 shelves
H110 cm	4 shelves
H128 cm	6 shelves

For other finishes,
please contact our Sales Department



ISO 9001



ISO 14001

UniFor has management system certified according to UNI EN ISO 9001 and UNI EN ISO 14001. The products are in conformance with the Italian decree law DLGS 81:2008 and with all of the principal regulations applicable to the various types of products.

The products described in this catalog are made with class E1 materials (low formaldehyde content) and are Greenguard® certified.